

**North America:** Danboro, PA • E-mail: info@pemnet.com • Tel: +1-215-766-8853

**Europe:** Galway, Ireland • E-mail: europe@pemnet.com • Tel: +353-91-751714

**Asia/Pacific:** Singapore • E-mail: singapore@pemnet.com • Tel: +65-6-745-0660  
Shanghai, China • E-mail: china@pemnet.com • Tel: +86-21-5868-3688

## Part # MPP-2mm-4, PEM® Type MPP™ Self-clinching microPEM® Pins - Metric

PEM Type MPP, self-clinching microPEM® pins are ideal for today's compact electronic assemblies. Simply pressed into a properly sized mounting hole, these micro pins clinch permanently into place. They can be installed into a variety of sheet materials up to HRB 92/HB 195 in hardness and they offer excellent corrosion resistance.

### Features and Benefits

- Satisfy demanding micro positioning and alignment applications.
- Head mounts flush into panels as thin as 0.5mm.
- Chamfered end makes mating hole

[+ more](#)

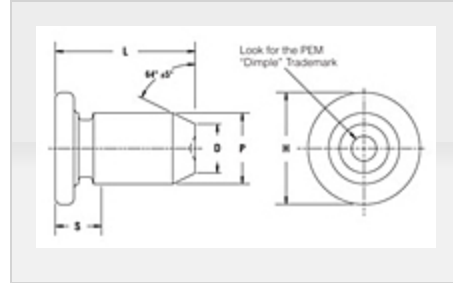

### Specifications

**Pin Diameter P ± 0.038** 2.00 mm

**L - Length ± 0.15** 4 mm

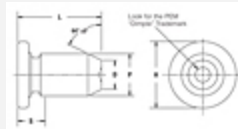

**Min. Sheet Thickness** 0.50 mm

**Hole Size in Sheet + 0.025** 2.05 mm

<b>D ± 0.1</b>	1.36 mm
<b>H ± 0.25</b>	3.02 mm
<b>S Max.(1)</b>	0.70 mm
<b>Min. Dist. Hole C/L to Edge</b>	4.40 mm
<b>Anvil Length</b>	7.18 mm
<b>For Use in Sheet Hardness<sup>(2)</sup></b>	HRB 92 / HB 195 or Less
<b>Fastener Material</b>	Age Hardened A286 Stainless Steel
<b>Standard Finish</b>	Passivated and/or tested per ASTM A380
<b>CAD Supplier</b>	PennEngineering® (PEM®)

1 Pin diameter may exceed max. in this region.

2 HRB - Hardness Rockwell "B" Scale. HB - Hardness Brinell