

North America: Danboro, PA • E-mail: info@pemnet.com • Tel: +1-215-766-8853

Europe: Galway, Ireland • E-mail: europe@pemnet.com • Tel: +353-91-751714

Asia/Pacific: Singapore • E-mail: singapore@pemnet.com • Tel: +65-6-745-0660
Shanghai, China • E-mail: china@pemnet.com • Tel: +86-21-5868-3688

Part # FHS-160-4, Self-Clinching Pins - Type FH, FHS, FHA - Unified

PEM® self-clinching studs are installed by placing them in properly sized holes in the sheets and squeezing into place with any standard press. The squeezing action embeds the head of the stud into the sheet. The metal displaced by the head flows smoothly and evenly around the ribs and into the annular groove – creating a flushhead assembly and securely locking the stud into the sheet with high torque-out and pushout resistances.

FH (flush-head) studs are available in aluminum, steel, or

[+ more](#)

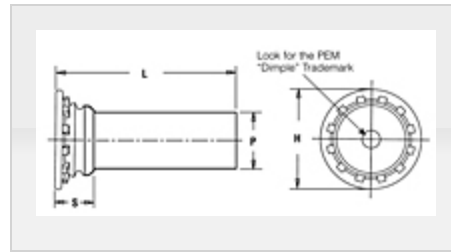

Specifications

Pin Dia. Code	160
Length Code	4
Min. Sheet Thickness	.040 in
Hole Size in Sheet + .003 - .000	.189 in
P - Nominal Pin Diameter ± .002⁽¹⁾	.160 in
L - Length ± .015	.250 in

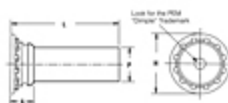

H ± .015	.260 in
S Max.(2)	.100 in
Min. Dist. Hole C/L to Edge	.28 in
For Use in Sheet Hardness	HRB 70 / HB 125 or Less
Fastener Material	300 Series Stainless Steel
Standard Finish	Passivated and/or tested per ASTM A380
CAD Supplier	PennEngineering® (PEM®)

1 Other pin diameters can be specified.

2 Pin diameter may exceed max. in this region.