

VARIABLE COILS

Dimensions in inches (mm)

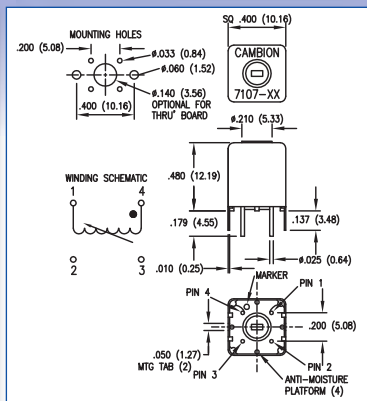
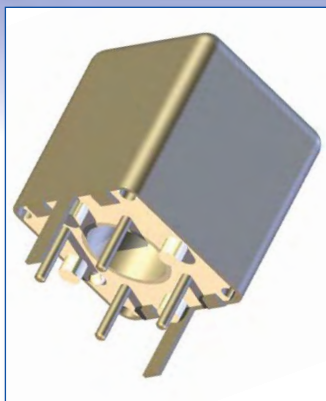

Core Material

- 01 to -13 Carbonyl SF (Blue)
- 14 to -25 Carbonyl TH (Purple)
- 26 to -37 Carbonyl E (Red)
- 38 to -49 Carbonyl C (Yellow)

How to order code

558 - 7107 - XX - 00 - 00

Basic Part No.

Inductance Code

Basic Part No.	Inductance (μH)		"Q" at L Min.	"Q" at L Max.	Test Frequency (MHz)	DCR Max. (Ω)	DC Max. (mA)	SRF Min. (MHz)	
	Min.	Max.							
558-7107	-01	0.090	0.110	65	65	25.0	0.031	2200	250
	-02	0.108	0.136	65	65	25.0	0.034	2100	250
	-03	0.135	0.165	70	70	25.0	0.037	2000	250
	-04	0.162	0.198	70	70	25.0	0.049	1750	250
	-05	0.198	0.245	70	70	25.0	0.055	1600	250
	-06	0.245	0.297	70	70	25.0	0.061	1500	250
	-07	0.297	0.363	70	70	25.0	0.067	1450	230
	-08	0.351	0.429	70	70	25.0	0.073	1400	220
	-09	0.423	0.517	70	70	25.0	0.080	1350	210
	-10	0.504	0.616	70	70	25.0	0.093	1300	200
	-11	0.612	0.748	70	70	25.0	0.093	1250	173
	-12	0.738	0.902	70	65	25.0	0.100	1200	150
	-13	0.900	1.10	70	65	25.0	0.110	1100	130
	-14	1.08	1.36	55	50	7.9	0.130	1000	120
	-15	1.35	1.65	50	45	7.9	0.140	1000	110
	-16	1.62	1.98	50	40	7.9	0.200	900	100
	-17	1.98	2.45	50	40	7.9	0.260	800	88
	-18	2.43	2.97	50	40	7.9	0.380	700	83
	-19	2.97	3.63	50	45	7.9	0.510	600	78
	-20	3.51	4.29	50	45	7.9	0.700	500	71
	-21	4.23	5.17	50	50	7.9	0.880	400	64
	-22	5.04	6.16	50	50	7.9	1.30	360	58
	-23	6.12	7.48	55	55	7.9	1.70	280	52
	-24	7.38	9.02	55	55	7.9	1.90	270	46
	-25	9.00	11.0	55	55	7.9	2.00	260	40
	-26	10.8	13.6	55	60	2.5	2.10	255	11
	-27	13.5	16.5	60	70	2.5	2.20	250	10
	-28	16.2	19.8	60	70	2.5	2.30	240	9.5
	-29	19.8	24.5	65	70	2.5	2.50	230	9.0
	-30	24.3	29.7	65	70	2.5	2.70	220	8.5
	-31	29.7	36.3	65	70	2.5	3.00	210	8.0
	-32	35.1	42.9	60	65	2.5	3.50	200	7.5
	-33	42.3	51.7	55	60	2.5	3.60	190	6.4
	-34	50.4	61.6	50	55	2.5	4.00	180	5.7
	-35	61.2	74.8	50	55	2.5	4.30	170	4.9
	-36	73.8	90.2	45	50	2.5	6.40	160	4.6
	-37	90.0	110	45	45	2.5	8.50	150	4.3
	-38	108	136	45	50	0.79	9.30	145	3.8
	-39	135	165	50	60	0.79	10.0	140	3.5
	-40	162	198	50	60	0.79	11.0	130	3.3
	-41	198	245	50	60	0.79	12.0	120	3.1
	-42	243	297	50	55	0.79	22.0	90	2.9
	-43	297	363	45	50	0.79	23.0	85	2.7
	-44	351	429	45	50	0.79	26.0	80	2.3
	-45	423	517	40	45	0.79	28.0	75	1.9
	-46	504	616	35	45	0.79	33.0	65	1.7
	-47	612	748	35	40	0.79	39.0	60	1.5
	-48	738	902	30	35	0.79	49.0	55	1.3
	-49	900	1100	30	35	0.79	60.0	55	1.2

Temperature Range: **-55°C to +105°C**

For RoHS Compliant add suffix **-LF** to the part number
 Windings are varnish impregnated and powdered iron cores are moisture proofed
 Recommended tuning tool 435-1522-01-00-00