

Part No	MPM Part No	DESCRIPTION
1210120012	B202000N1	BAS QUAD.202 NERA 2FIX.SA
1210120013	B202000N2	PLATTE 2+ERDE 2-DIAGONAL
1210120015	B202000N4	PLATTE 2+ERDE 2-DIAGONAL
1210120016	B202000N6	BAS QUAD.202 NERA 2FIX.SA
1210120131	B202000W4UR	BAS202 NERA 2FIX.SA UL
1210120161	B202000G2	BAS QUAD.202 GRIGIA 2P+T
1210140001	B202000W2UR	BAS202 NERA 2FIX.SA UL
1210120168	B202000W2SA	BAS202 NERA UL94 V0 UL LISTED
1210120169	B203000W2SA	BAS203 NERA UL94 V0 UL
1210120019	B203000N2	STD. BASE 3 POLE+EARTH FLAT

ITEM	DESCRIPTION
1	CENTRE SCREW
2	FIXING SCREWS
3	BASE
4	GASKET

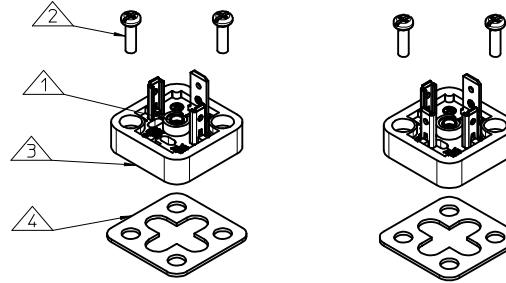

B202 SERIES BASE

B203 SERIES BASE

B202000N2\*\*

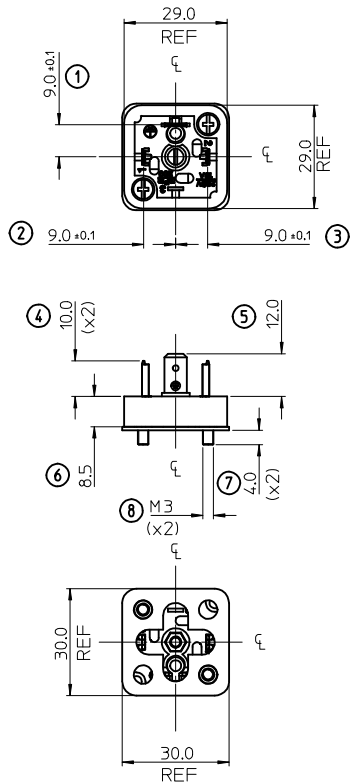

SERIES \_\_\_\_\_  
 B20= FORM A BASE SERIES  
 POLES \_\_\_\_\_  
 2= 2 POLE & 3= 3 POLE  
 CURVED BASE DIAMETER \_\_\_\_\_  
 000 = FLAT  
 MATERIAL AND HOUSING COLOR \_\_\_\_\_  
 G= PA6 GRAY, N= PA6 BLACK, W= PA6 BLACK V0  
 GASKET & SCREWS \_\_\_\_\_  
 1= NBR INTEGRATED GASKET & SCREWS  
 2= NBR FLAT GASKET & SCREWS  
 4= SILICON FLAT GASKET & SCREWS  
 0= WITHOUT GASKET AND SCREWS  
 ADDITIONAL INFORMATION  
 UR= UL APPROVED  
 SA= UL LISTED

NOTES

- FOR SPECIFIC PART NUMBERS PLEASE CONTACT SALES OR CONSULT THE INTELLIGENT PART NUMBERS IN THE TABLE ATTACHED
- PRODUCT SPEC: SEE PS-121201-001
- PACKAGING SPEC: SEE PK-121012-B20

LAST INSPECTION NUMBER USED 8

ADDED PART NUMBER	DESCRIPTION	QUALITY SYMBOLS		GENERAL TOLERANCES (UNLESS SPECIFIED)		DIMENSION STYLE		SCALE	DESIGN UNITS	THIRD ANGLE PROJECTION
		mm	INCH	mm	INCH	MM ONLY	1:1	METRIC	THIRD ANGLE PROJECTION	
EC NO: IPG2013-4132	2013/01/28	▽=0	▽=0	4 PLACES ± ---	± ---	DRAWN BY	DATE	TITLE	B20 SERIES BASES	
DRWN:DSHEA	2013/01/29	▽=0	▽=0	3 PLACES ± ---	± ---	DMAHER_WEU	2010/03/18			
CHKD:SMCGREY	2013/02/08			2 PLACES ± 0.10	± ---	CHECKED BY	DATE			
APPR:STGERFFIN				1 PLACE ± 0.20	± ---	APPROVED BY	DATE			
				ANGULAR ± 2 °		JWALLACE	2010/03/24			
				DRAFT WHERE APPLICABLE MUST REMAIN WITHIN DIMENSIONS		MATERIAL NO.				
						SEE TABLE				
						SIZE				
						A2				
						THIS DRAWING CONTAINS INFORMATION THAT IS PROPRIETARY TO MOLEX INCORPORATED AND SHOULD NOT BE USED WITHOUT WRITTEN PERMISSION				