

## ME MAX 17,5 U-U1 KMGY

Order No.: 2713641

The illustration shows the version ME MAX 17,5 2-2 KMGY with DIN rail connector plugged in



<http://eshop.phoenixcontact.de/phoenix/treeViewClick.do?UID=2713641>

Electronic housing consisting of: Housing shells left and right, front plate, transparent cover, metal foot catch and spring, open housing, 3-pos. (1 x 3 pos.), width: 17.5 mm, color: Light gray

Commercial data	
GTIN (EAN)	4017918936150
sales group	F052
Pack	10 pcs.
Customs tariff	85369010
Weight/Piece	0.05506 KG
Catalog page information	Page 585 (CC-2009)

#### Product notes

WEEE/RoHS-compliant since:  
04/01/2005



<http://www.download.phoenixcontact.com>  
Please note that the data given here has been taken from the online catalog. For comprehensive information and data, please refer to the user documentation. The General Terms and Conditions of Use apply to Internet downloads.

Technical data	
<b>General</b>	
Housing type	Complete housing
Housing material	Polyamide
Color	light gray

### Dimensions / positions

Length	99 mm
Constructional height	114.5 mm
Width	17.5 mm
Number of positions	3

### Technical data

Ambient temperature (operation)	-40 °C ... 105 °C
Inflammability class acc. to UL 94	V0
Power dissipation at 20°C in the horizontal mounting position	5.2 W 10.8 W

### Certificates / Approvals



Certification CUL, UL

### Accessories

Item	Designation	Description
2908294	ME FE-CONTACT	Functional earth ground contact, for intermediate elements.

### Diagrams/Drawings

Explosion drawing

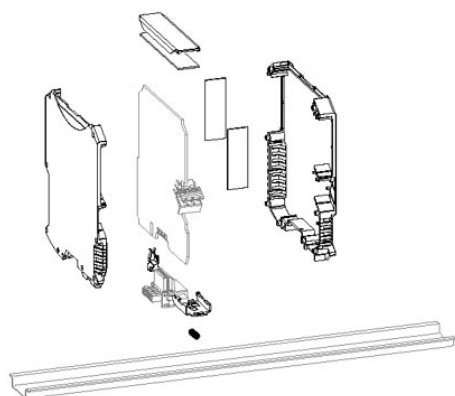

The illustration shows a version of the product (open housing) with accessories

Dimensioned drawing

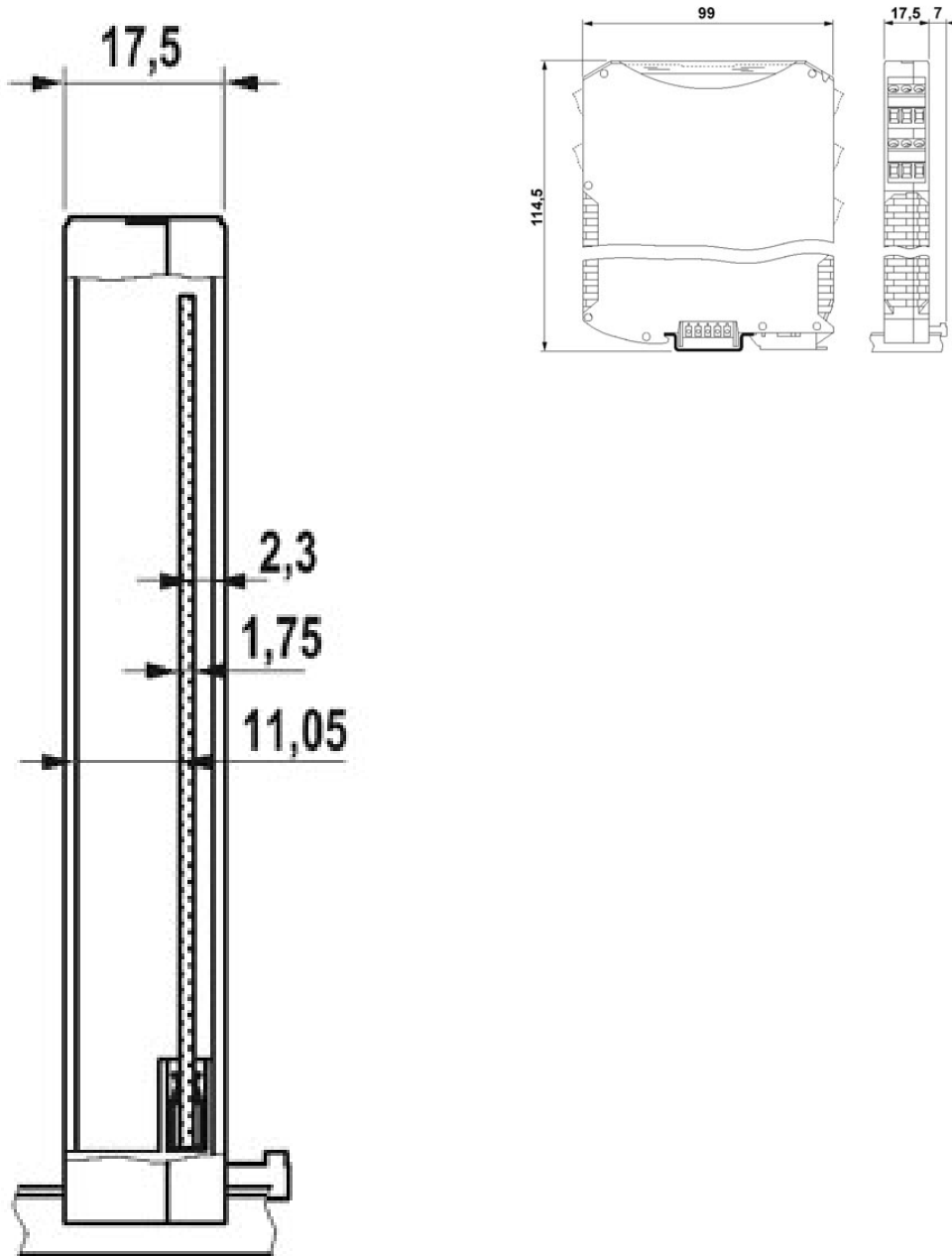

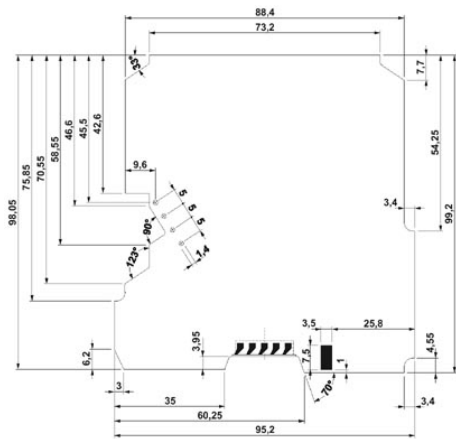

Dimensional drawing of the ME MAX U-U1 printed circuit board, for printed circuit terminal block connection (MKDSO), view: component side

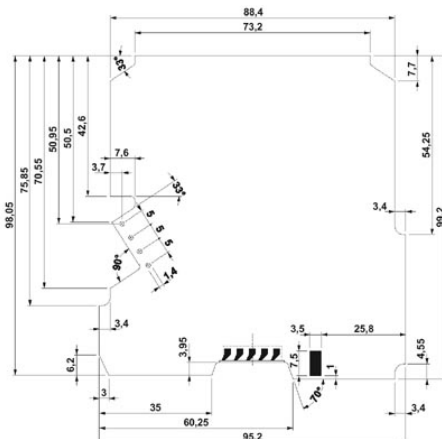

Dimensional drawing of the ME MAX U-U1 printed circuit board for plug connection (MSTBO), view: component side

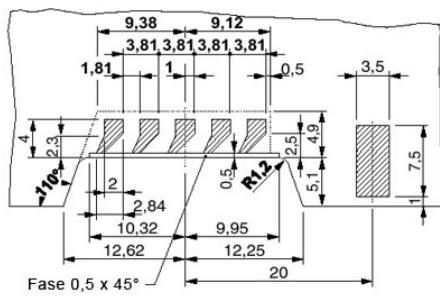

Detailed dimensional drawing of the DIN rail connector contact pads

**Address**

PHOENIX CONTACT Inc., USA  
586 Fulling Mill Road  
Middletown, PA 17057, USA  
Phone (800) 888-7388  
Fax (717) 944-1625  
<http://www.phoenixcon.com>



© 2010 Phoenix Contact  
Technical modifications reserved;