

# D款, 正向10.0前两脚, DIP-\*5.70

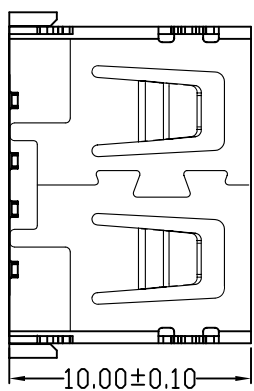
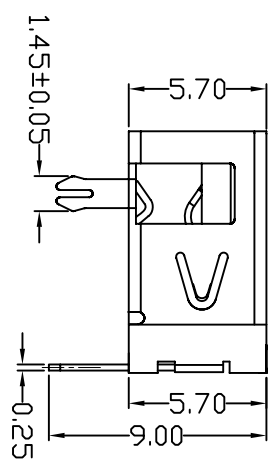
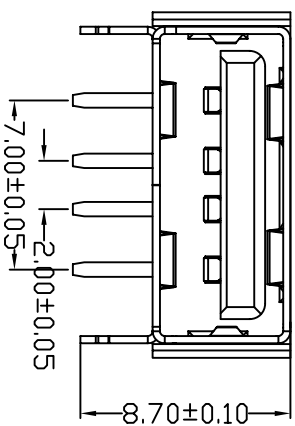
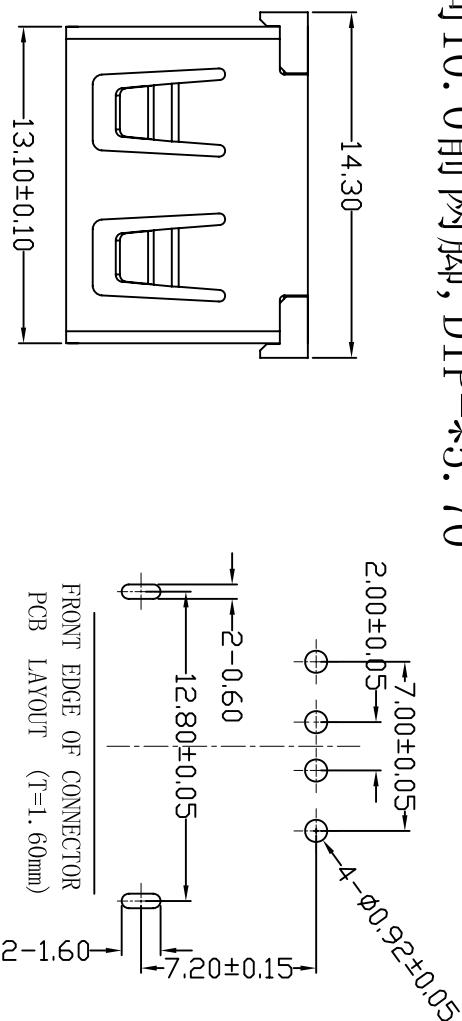

MAPX	MODIFICATION	DATE

NOTES:  
 1. HOUSING: SEE NOTES, UL94V-0 .  
 TERMINAL: SEE NOTES.  
 SHELL: SEE NOTES.  
 SPECIFICATION:

1. ELECTRICAL CHARACTERISTIC:  
 CONTACT RESISTANCE: 30MΩ MAX  
 DIELECTRIC WITHSTANDING VOLTAGE: 500V AC FOR 1MIN  
 INSULATION RESISTANCE: 1000MΩ MIN  
 2. MECHANICAL CHARACTERISTIC:  
 INSERTION FORCE: 35N(3.57KGF) MAX  
 EXTRACTION FORCE: 10~35N(1.02~3.57KGF)/MIN  
 DURABILITY: 1500 CYCLES EXTRACTION FORCE: 10~35N  
 5000 CYCLES MIN  
 5000 CYCLES EXTRACTION FORCE: 3~35N

3. ENVIRONMENTAL:  
 OPERATING TEMPERATURE: -55°C+85°C  
 4. Contact finish:  
 01: Selective Gold Flash  
 02: Selective Gold 3U"  
 03: Selective Gold 5U"  
 04: Selective Gold 15U"  
 05: Selective Gold 30U"

## 产品图

## 深圳市精拓金电子有限公司

公差一览表		单位		制图		制图料号	
TOLERANCE	UNLESS OTHERWISE	UNITS	MM	DRAWING	Z-Y-B	PRODUCT PART NO.	JTY-USB-10.0-006
X	±0.25	X	±5°	审核		产品名称	USB A/P 10.0无边前两脚鱼叉(方弹)
X	±0.20	X	±2°	CHKD		PRODUCT NO.	
XX	±0.15	XX	±1°	核准		角法	
XXX	±0.10	XXX	±0.5°	APPD		版本	AD
DATE	20120924	DATE				VER	

1 2 3 4 5 6 7 8 9 10