

Recommended P.C. Board Layout
SCALE 4:1

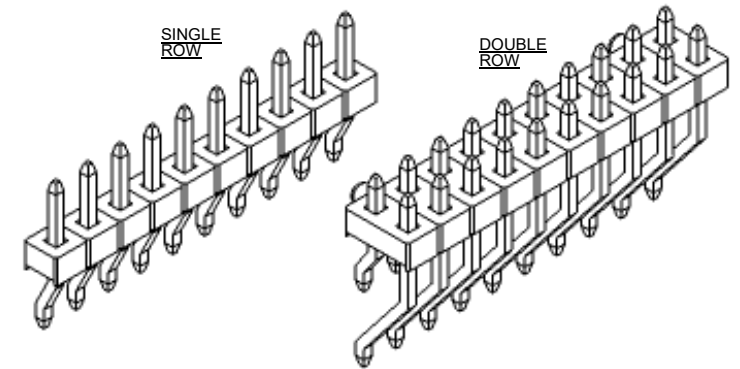

TSHSM-2 [XX] - [X] - [XX] - [XX] - [H] - [XXX] - [XX] - [X] - [XX] - [LF]
(A) (B) (C) (D) (E) (F) (G) (H) (I) (J)

APPLICATION

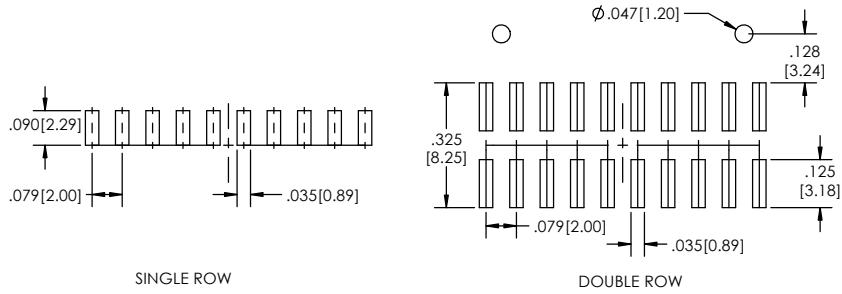
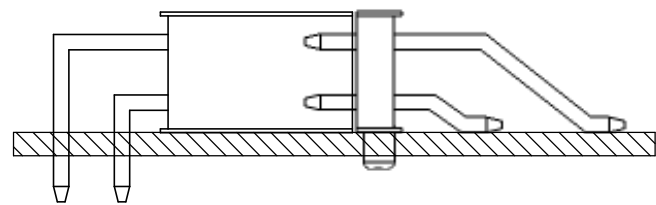

- A. Pins Per Row
 - 1 through 40
- B. Row Specification
 - S= Single Row
 - D= Double Row
- C. Pin Options
 - See Pin Options below
- D. Plating Options
 - See Plating Options below
- E. Horizontal
- F. Polarized Position
 - Leave blank if not needed
 - If required, specify empty pin position
 - e.g. 012 for Pin 12
- G. Packing Information
 - TR= Tape and Reel
 - TB= Tube
- H. Pad
 - P= Plastic
 - K= Kapton
 - O= No Pad
 - If left blank, packaging at MLE's discretion
 - Pad may be metal, mylar or plastic
- I. Alignment Pin (Option only for Double Row)
 - Leave blank if not needed
 - AP= with
- J. Lead Free

- Mates with:
- BCSS.
 - BSSH.
 - BSSHC.
 - BSSQ.
 - BSSQC.
 - BSSQM.
 - LSMBC.
 - LSSHSM.
 - SMBC.
 - SSHQ.
 - SSHQR.
 - SSHR.
 - SSHS.
 - SSHSM.
 - ULSMBC.

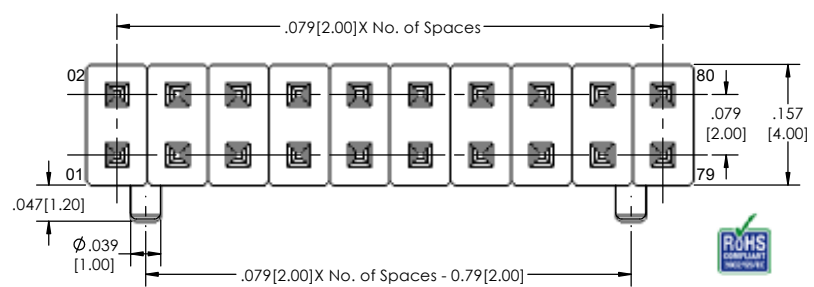
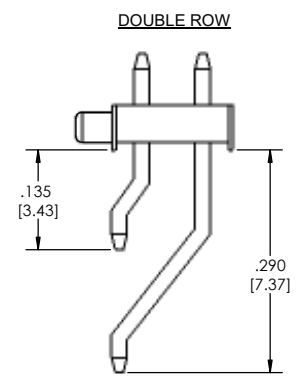
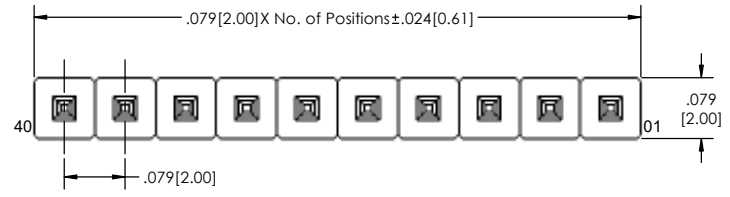
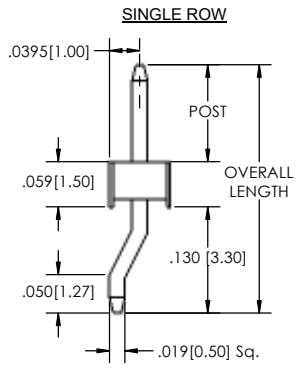

Plating options	
G	-10µ Gold on Contact Area/ Flash on Tail
T	-Matte Tin all Over
GT	-10µ Gold on Contact Area/ Matte Tin on Tail
H	-30µ Gold on Contact Area/ Matte Tin on Tail
F	-Gold Flash over Entire Pin
FT	- Gold Flash on Contact Area/ Matte Tin on Tail

Specifications:
 Current Rating: 3.0 Ampere
 Insulation Resistance: 1000M Ohms Min.
 Dielectric Withstanding: 500V AC
 Contact Resistance: 20M Ohms Max.
 Operation Temperature: -40°C to +105°C
 Max. Process Temperature
 Peak: 260°C up to 10 secs.
 Process: 230°C up to 60 secs.
 Wave: 260°C up to 6 secs.
 Reflow: 260°C up to 10 secs.
 Manual Solder: 350°C up to 5 secs.

Materials:
 Contact Material: Phosphor Bronze
 Insulator Material: Nylon 6T
 Plating: Au or Sn over 50µ" (1.27) Ni

Pin Option		
Post Length	Overall Length	
.126[3.20mm]	.323[8.13mm]	02
.175[4.45mm]	.372[9.45mm]	03
.200[5.08mm]	.397[10.10mm]	04
.220[5.59mm]	.417[10.59mm]	06
.358[9.09mm]	.555[14.10mm]	08
.378[9.60mm]	.575[14.61mm]	10
Double Row		
Post Length	Overall Length	
.126[3.20mm]	.475[12.06mm]	02
.175[4.45mm]	.524[13.31mm]	03
.200[5.08mm]	.549[13.94mm]	04
.220[5.59mm]	.569[14.45mm]	06
.358[9.09mm]	.707[17.95mm]	08
.378[9.60mm]	.727[18.46mm]	10

Tails may be clipped to achieve specific dimensions.
 Products cut to specific sizes are uncancelable/ nonreturnable.
 Parts are subject to change without notice.

PROPRIETARY AND CONFIDENTIAL
 THE INFORMATION CONTAINED IN THIS DRAWING IS THE SOLE PROPERTY OF Major League Electronics. ANY REPRODUCTION IN PART OR AS A WHOLE WITHOUT THE WRITTEN PERMISSION OF Major League Electronics IS PROHIBITED.



UNLESS OTHERWISE SPECIFIED:		NAME DATE		
DIMENSIONS ARE IN INCHES		DRAWN	EOW 10/11/16	
TOLERANCES: ONE DECIMALS ±.100 TWO DECIMAL ±.005 THREE DECIMAL ±.002 FOUR DECIMAL ±.002		CHECKED	GWG 10/11/16	
NEXT ASSY USED ON		ENG APPR.		
APPLICATION		MFG APPR.		ADDRESS: 2533 Centennial Blvd. Jeffersonville, IN 47130 Phone: 812-670-4174 Fax: 812-670-4175 E-Mail: mle@mlelectronics.com
DO NOT SCALE DRAWING		FINISH		TITLE: TSHSM-2-H SERIES SIZE DWG. NO. C
				REV F SCALE 8:1 SHEET 1 OF 1