

SCHEMATIC

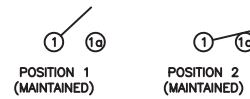

SPECIFICATIONS

FUNCTION:
1P1T OFF-ON

RATINGS:
ANSI/JUL 1054 and CAN/CSA C22.2 No. 55 (E194579):
16A 125VAC [UR, cUR]
10A 250VAC [UR, cUR]
1/3HP 125/250VAC [UR, cUR]

CONTACT RESISTANCE:
Initial: 35mΩ Max. at 50VAC

INSULATION RESISTANCE:
100MΩ Min. at 500VDC

DIELECTRIC STRENGTH:
1,500VAC For 1 Minute

ELECTRICAL LIFE:
6,000 Cycles [UR, cUR]

TEMPERATURE:
Operating: -20°C to 105°C [UR, cUR]

APPROVALS:

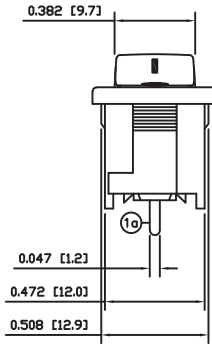
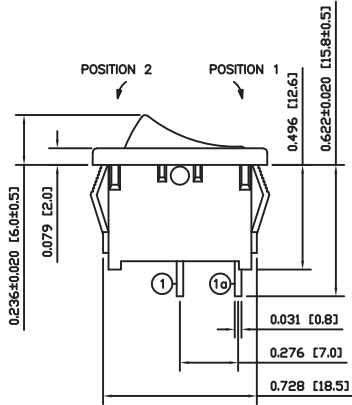
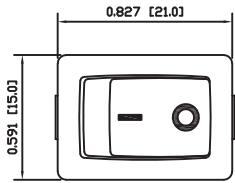

COLORS AND MARKINGS

BODY:
Black

ACTUATOR:
Black

MARKINGS:
I/O Vertical (1)

MARKING COLOR:
White

MATERIALS

BODY:
Polyamide 6/6 (PA66), UL94 V-2

ACTUATOR:
Polyamide 6/6 (PA66), UL94 V-2

SPRING:
Steel

BALL:
Steel

MOBILE CONTACT:
Silver Alloy

CONTACTS:
Silver Alloy

TERMINALS:
Silver Plated Copper

SUGGESTED PANEL CUTOUT

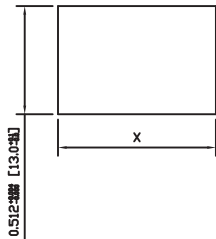

| PANEL THICKNESS | X |
|-------------------------|--------------|
| 0.030~0.049 [0.75~1.25] | 0.756 [19.2] |
| 0.049~0.079 [1.25~2.00] | 0.764 [19.4] |
| 0.079~0.118 [2.00~3.00] | 0.772 [19.6] |

SUGGESTED PCB CUTOUT



| ACTUATOR | A | 09/05/04 | CAB |
|----------------|------|----------|-----|
| BODY | A | 09/05/04 | CAB |
| COLORS | A | 09/05/04 | CAB |
| MATERIALS | A | 09/05/04 | CAB |
| SPECIFICATIONS | B | 09/08/13 | CAB |
| REFERENCE | REV. | DATE | BY |

THE INFORMATION CONTAINED IN THIS DOCUMENT IS PROPRIETARY TO E-SWITCH-LAMB INDUSTRIES AND IS NOT TO BE COPIED OR TRANSFERRED

| REV. | DESCRIPTION | DATE | DATE | DRAWN BY |
|------|---------------------------------|--------|------------|----------|
| C | REMOVE VDE/ENEC RATING AND LOGO | 100450 | 01/07/2022 | JS |
| B | REMOVED SEMKO RATING | 23425 | 06/28/18 | MJR |
| A | INITIAL RELEASE | 18970 | 10/03/30 | CAB |

| DIMENSIONS | |
|----------------------|---------------|
| INCHES | [MILLIMETERS] |
| GENERAL TOLERANCES | |
| ±0.008 [±0.2] / ±1' | |
| SCALE | PROJECTION |
| DRAWING NOT TO SCALE | 1st Angle |

OBJECT ID: 000001406

RA131C1121

| | |
|-------------------------------------|------------------------|
| ITEM NUMBER 38-RA131C1121 | DATE MARCH 30, 2010 |
| REVISION C | |