

950-SLS

Pin Strip
Plug-in direction parallel to PCB

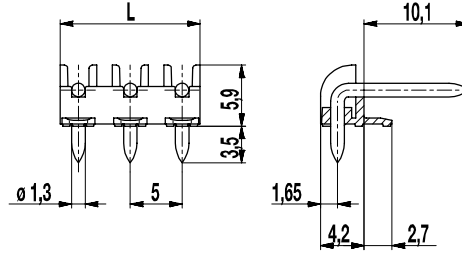
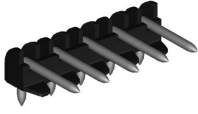

GENERAL INFORMATION

Pitch	5 mm
No. of poles	2 - 24

TECHNICAL DATA

Overvoltage Category	III	III	II
Pollution Severity Level	3	2	2
Rated Voltage	250 V	320 V	500 V
Rated Impulse Voltage	4 kV	4 kV	4 kV
Rated Insulation Voltage	250 V acc. to EN 60998-1		
Rated Current	6 A		
Hole in PCB	ø 1,6 mm		

APPROVALS

	Current [A]	Voltage [V]	Group	AWG	[Nm]
	10	300	B		
	10	300	B		

MATERIAL

Moulding	PA, grey, V-0
Comparative Tracking Index	CTI 400
Insulating Group	II
Temperature Range	-40°C up to 100°C
Solder pin	ø 1,3 mm; tin plated brass

OPTIONS / ACCESSORIES

- Pitch of 10 mm for larger clearance and creepage distances
- Other pin lengths on request
- Other pin surfaces on request

CONFIGURATIONS

Poles	Part number	Article number	Length (L)	Packaging	PU
2	950-SLS/02	12.893.101	8,50 mm	Box	1000
3	950-SLS/03	13.893.101	13,50 mm	Box	500
4	950-SLS/04	14.893.101	18,50 mm	Box	250
5	950-SLS/05	15.893.101	23,50 mm	Box	250
6	950-SLS/06	16.893.101	28,50 mm	Box	250

