

THIS COPY IS PROVIDED ON A RESTRICTED BASIS AND IS NOT TO BE USED IN ANY WAY DETRIMENTAL TO THE INTERESTS OF PANDUIT CORP.

PANDUIT PART NO.	WEIGHT
CHBH**	.16 LB/10 PCS [72 g/10 PCS]

NOTES:

1. IDENTIFICATION: HOODED PASS-THROUGH BEZEL INSERT
2. DIMENSIONS IN [] ARE IN METRIC
3. PRODUCT AND PACKAGING MUST COMPLY TO PANDUIT SPECIFICATION FOR CHEMICAL SUBSTANCES TO BE CONTROLLED IN PANDUIT PRODUCT AND PACKAGING PER C2-0834 AND C2-0835.

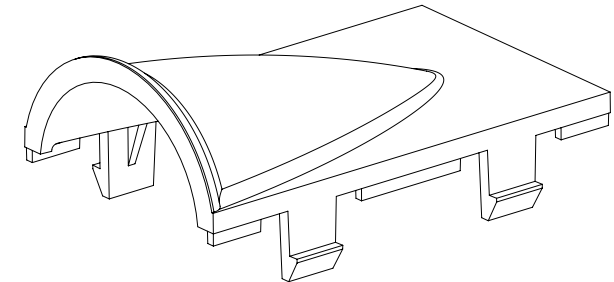
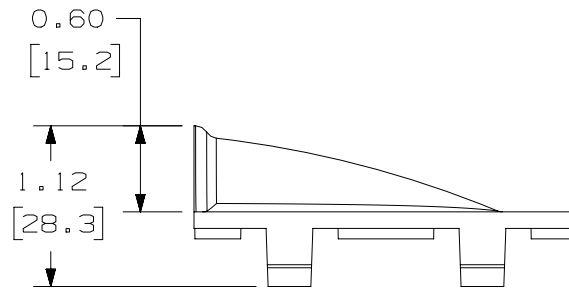
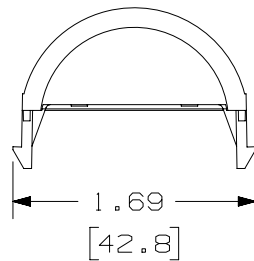
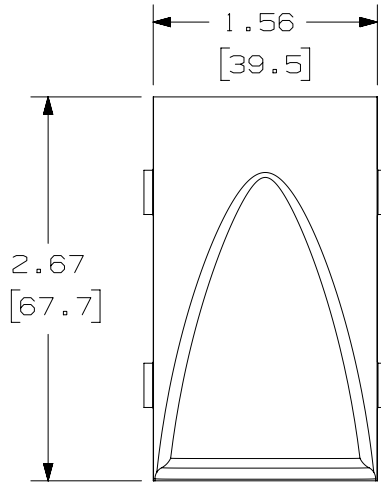

ACTUAL SIZE

PART NUMBER		CHBH**	
TITLE		HOODED PASS-THROUGH BEZEL INSERT	
CUSTOMER DRAWING			
ITEM REVISION NAME	00143NBA/08	PANDUIT	
DATASET FILE NAME	00143NBA_DC02/08A		
UNLESS OTHERWISE SPECIFIED, DIMENSIONAL TOLERANCES ARE: IN [mm]		MATERIAL:	
.x ± .1 [2.54]	.xxx ± .005 [.127]	ABS	
.xx ± .01 [.25]	ANGLES ± 5 °	DRAWING NUMBER:	
THIRD ANGLE PROJECTION		00143NBA-02	
DRAWN BY	DATE	CHK	SCALE
BJN	2-20-17	JAV	NONE
SHT 1 OF 1		SIZE	
A		A	

REV	DATE	BY	CHK	APR	DESCRIPTION	ECN
6	6-07-18	MDJR	MDJR	AMY	UPDATED CAD MODEL TO NEW REVISION	00143NBA-02
5	5-16-18	MDJR	MDJR	AMY	UPDATED CAD MODEL TO NEW REVISION	00143NBA-02
4	04-26-18	MDJR	MDJR	MDJR	NO CHANGES MADE, UPDATED TO MATCH NEW DATASET REVISION	00143NBA-02
3	03-22-18	MDJR	MDJR	AMY	REVISED PART NUMBER, WAS CMHPTN**.	00143NBA-02
2	2-14-18	MDJR	MDJR	AMY	UPDATED ROHS NOTE TO NEW MAT. COMPLIANCE NOTE.	00143NBA-02
1	2-21-17	BJN	JAV	AMY	RELEASED TO PRODUCTION	00143NBA-02
R	2-20-17	BJN	JAV	AMY	REV R NOT RELEASED TO PRODUCTION	00143NAB-02

D10100DA/20